

Patient Care Choreography: Why Wearable Works

gelFAST Typical Care Scenario In-Room Destination Points:

- 1 Adjust Monitor
- 2 Patient contact (**gelFAST**)
- 3 Update charts
- 4 Patient contact (**gelFAST**)
- 5 Adjust IV
- 6 Adjust dressings (**gelFAST**)
- 7 Exit room, to next patient (**gelFAST**)

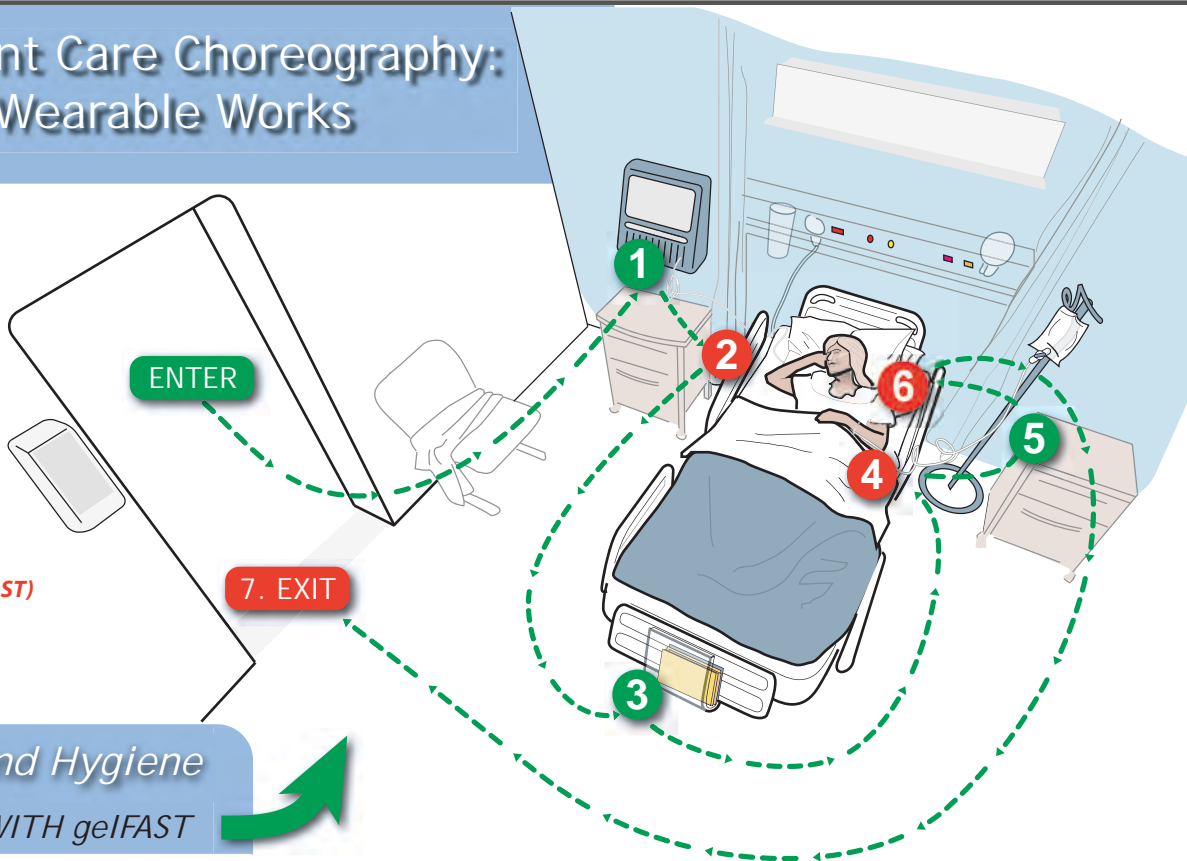

Proper Hand Hygiene

WITH gelFAST

WITHOUT gelFAST

Wall-mount Gel Care Scenario In-Room Destination Points:

- 1 Adjust Monitor
- 2 Wall-mounted alcohol gel
- 3 Patient contact
- 4 Update charts
- 5 Wall-mounted alcohol gel
- 6 Patient contact
- 7 Adjust IV line
- 8 Wall-mounted alcohol gel
- 9 Adjust dressings
- 10 Wall-mounted alcohol gel
- 11 Exit room, to next patient.

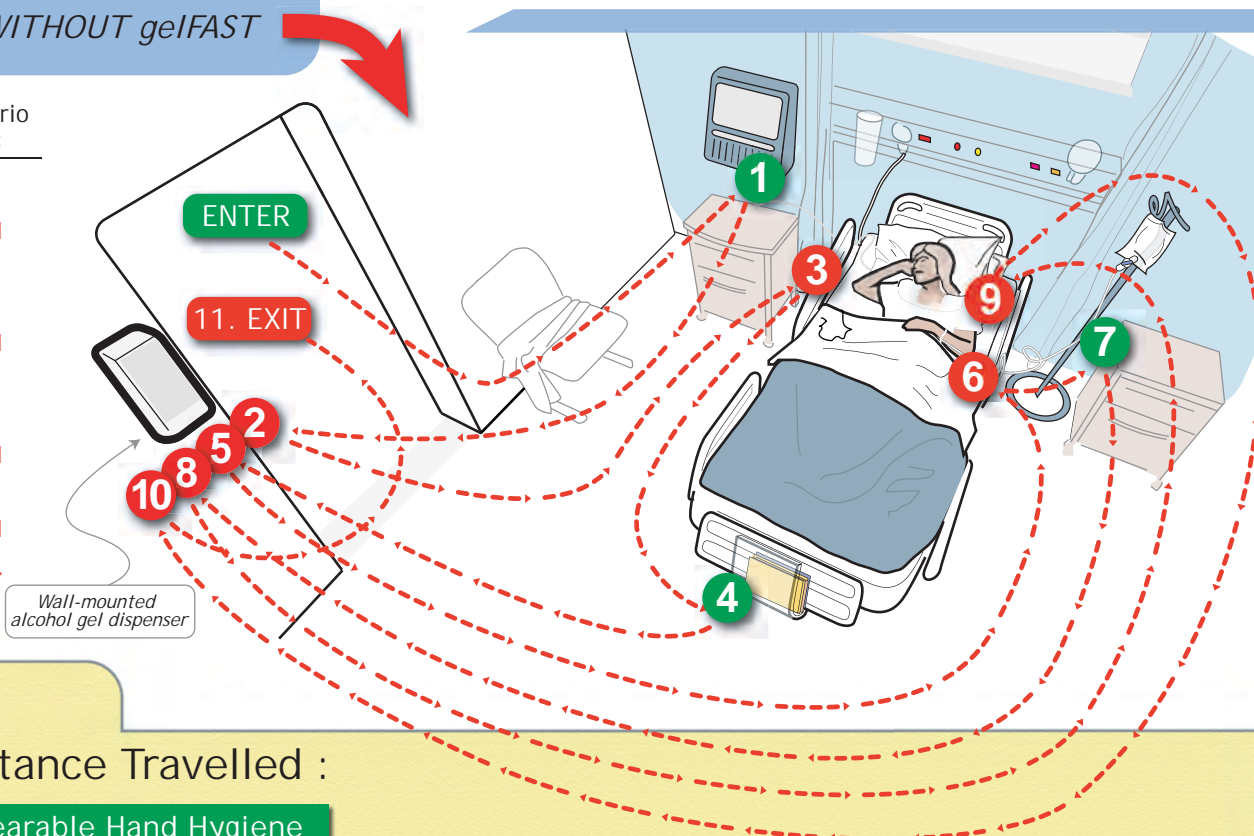

SUMMARY

Total Distance Travelled :



gelFAST Wearable Hand Hygiene



Typical Wall-mounted Alcohol

*Extra travel solely due to adhering to hand hygiene guidelines.

Conclusion: The sheer number of patient and object interactions in a typical workflow choreography illustrates why a wearable rapid-application alcohol gel dispenser is the most practical way of adequate hand hygiene rates.

gelFAST Alcohol Gel Wearables

- > Making Hand Hygiene Second Nature
- > Making Compliance Easy

Hand Hygiene: The Rules

Indications for Hand Antisepsis using an Antiseptic Alcohol Gel

BEF-PAT
Before Patient

Before contact with patient.

AFT-PAT
After Patient

After contact with patient (included when leaving by touching patient's environment).

BEF-INV
Before Invasive

Before aseptic or invasive contact or care.

AFT-BFG
After Body Fluid
(Gloved)

Immediately after potential or effective exposure to body fluids, even when contact happens with gloves.

AFT-OBJ
After Object

After contact with patient's environment

- Caregivers must clean hands very often, but...
- Hand hygiene requirements are high, yet compliance is low:
- Average Caregiver Hand Hygiene Frequency: below 40%

WEARER OPTIONS:

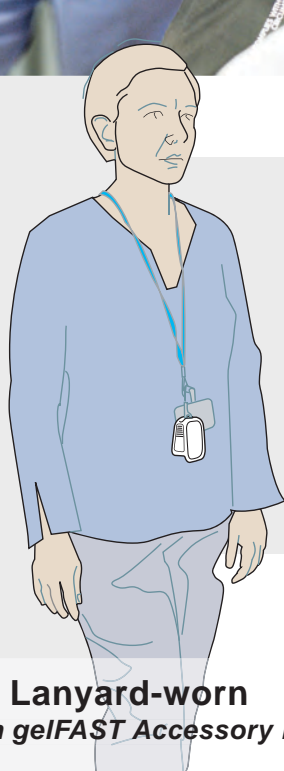

Lanyard-worn
(with gelFAST Accessory Kit)

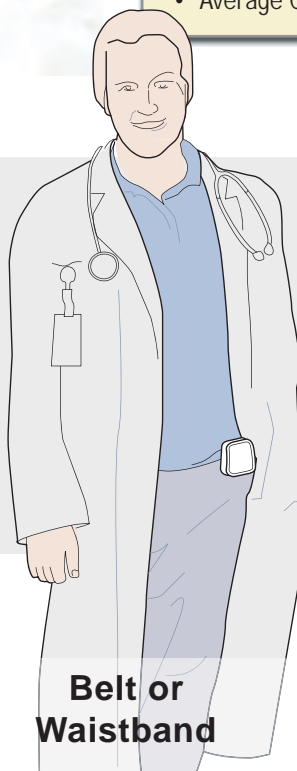

**Belt or
Waistband**

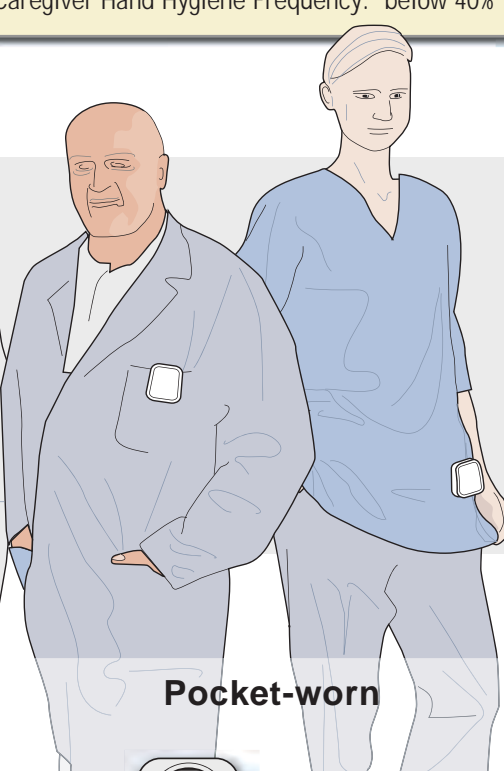

Pocket-worn

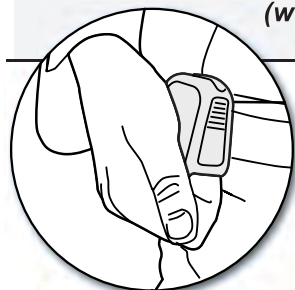

gelFAST
anywear

... when you are serious about hand hygiene.

Medonyx Inc.

tel: 1 (866) MEDONYX
1 (866) 633-6699
fax: 1 (815) 301-9278

341 Lesmill Rd.
Toronto, Ontario
Canada M3B2V1
info@medonyx.com
www.medonyx.com

